



Variety Mfg. Co.

Manufacturers of
**Building
Specialties**

Chicago, Illinois

Variety Manufacturing Company

Manufacturers of
DOORS

BRANCH OFFICES

- Indianapolis, Ind.: Fire Protection & Equipment Co.
Los Angeles, Cal.: B. C. Sutton, 530 Grosse Bldg.
Mexico City, Mex.: G. A. E. Larson
Calle de Don Juan Manuel No. 10
Milwaukee, Wis.: Consolidated Sheet Metal Works
661 Hubbard St.
Minneapolis, Minn.: Variety Fire Door Co., 123 Western Ave.
New Orleans, La.: American Sheet Metal Works
Carrollton and Edinburg Sts.
New York, N. Y.: George N. Cole, 277 Broadway
Boston, Mass.: Walter G. Hall, Beacon Chambers
Omaha, Neb.: Sunderland Brothers Company
1608 Harney St.
Pittsburg, Penn.: Mullen Brothers Company
715 Fulton Bldg.
Portland, Ore.: H. A. Heppner & Co.
St. Louis, Mo.: St. Louis Fire Door Co.
Cass and Collins Sts.
Seattle, Wash.: Pacific Coast Dry Kiln Co.
Winnipeg, Man.: Grose & Walker, 261 Stanley St.

Main Office and Factory
CHICAGO, ILL.

To the Trade

THIS booklet contains a few cuts showing only articles of which we are large manufacturers.

We make more Fire Doors than any other concern in the world.

We pay expressage both ways on plans and specifications; take off quantities and return plans one day after receiving them, with our figure; guarantee everything in *Fire Doors* which we furnish to be acceptable to either the National Board or the Factory Mutuals; furnish detailed drawings to erect work by, if it is sold f. o. b. On large jobs will send competent superintendent.

Cross Freight Elevator Doors

Our Cross Freight Elevator Door is constructed entirely of iron and is without question the best door on the market for a freight shaft. Costs nothing to maintain — easy to operate — nothing to get out of order — always out of the way — is fireproof and recommended by the Factory Mutuals.

Cross Horizontal Folding Doors

Our Cross Folding Door is the best door on the market for outside openings where wood construction will be acceptable. Nothing to rust out — nothing to wear out — easy to operate — always out of the way. If by chance it is broken, any ordinary mechanic can fix it. Everything about it is in plain view. It spells simplicity. Cost of maintenance is nothing. Light can be admitted by having glass in the upper half. Will last a lifetime. Made of any material from wood to concrete.

Rolling Shutters

Slat Shutters, the strongest and stiffest made, every slat uniform. We can send others if by chance a door should be put out of order. They are interchangeable. Made as heavy as No. 16 gauge steel. Everything connected with it is wrought steel or iron. We use no cast-iron brackets, etc.; they break; wrought can't break.

Without a question it's the best.

Cross Counterbalance Freight Elevator Door

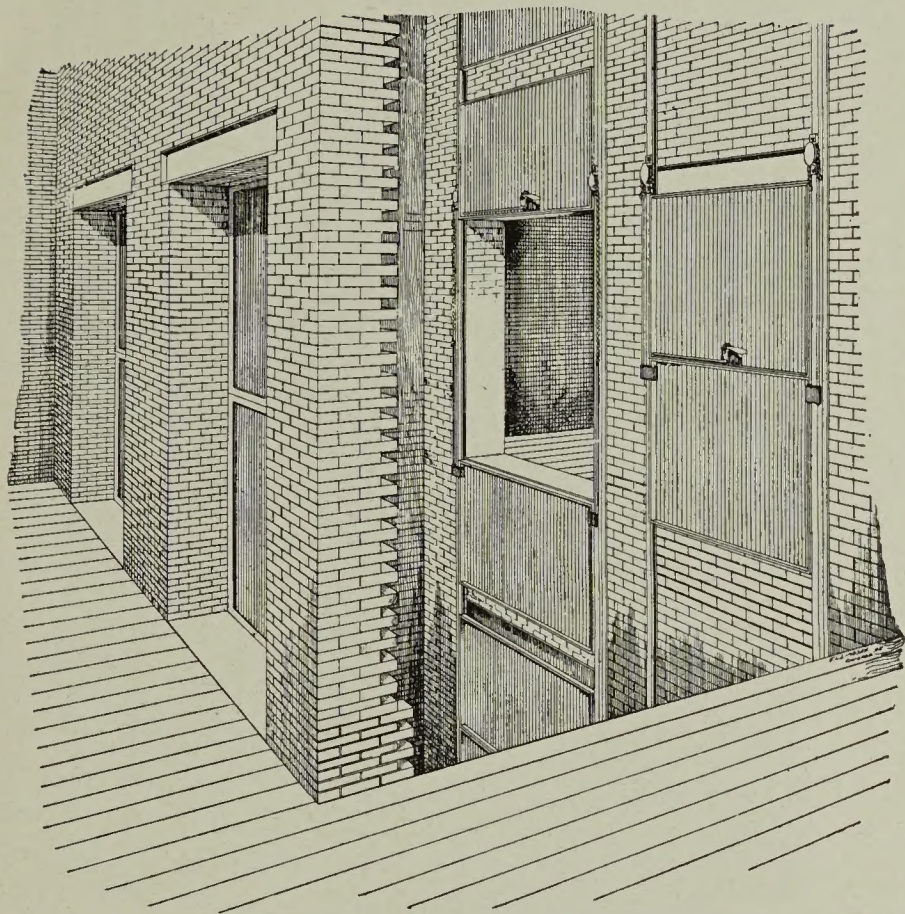

Looking through a hatch equipped with the Cross Counterbalance Freight Elevator Door, showing some doors open, some closed. Door is built of black or galvanized corrugated iron as heavy as No. 20, riveted to an angle frame. Slides in guides on inside of shaft. Absolutely fireproof—easy to operate—nothing to get out of order. Takes up no room—self-counterbalanced—no weights or springs.

Can also be made of wood core covered with tin. Can readily be made self-closing.

We furnish detailed drawings.

Cross Counterbalance Freight Elevator Door

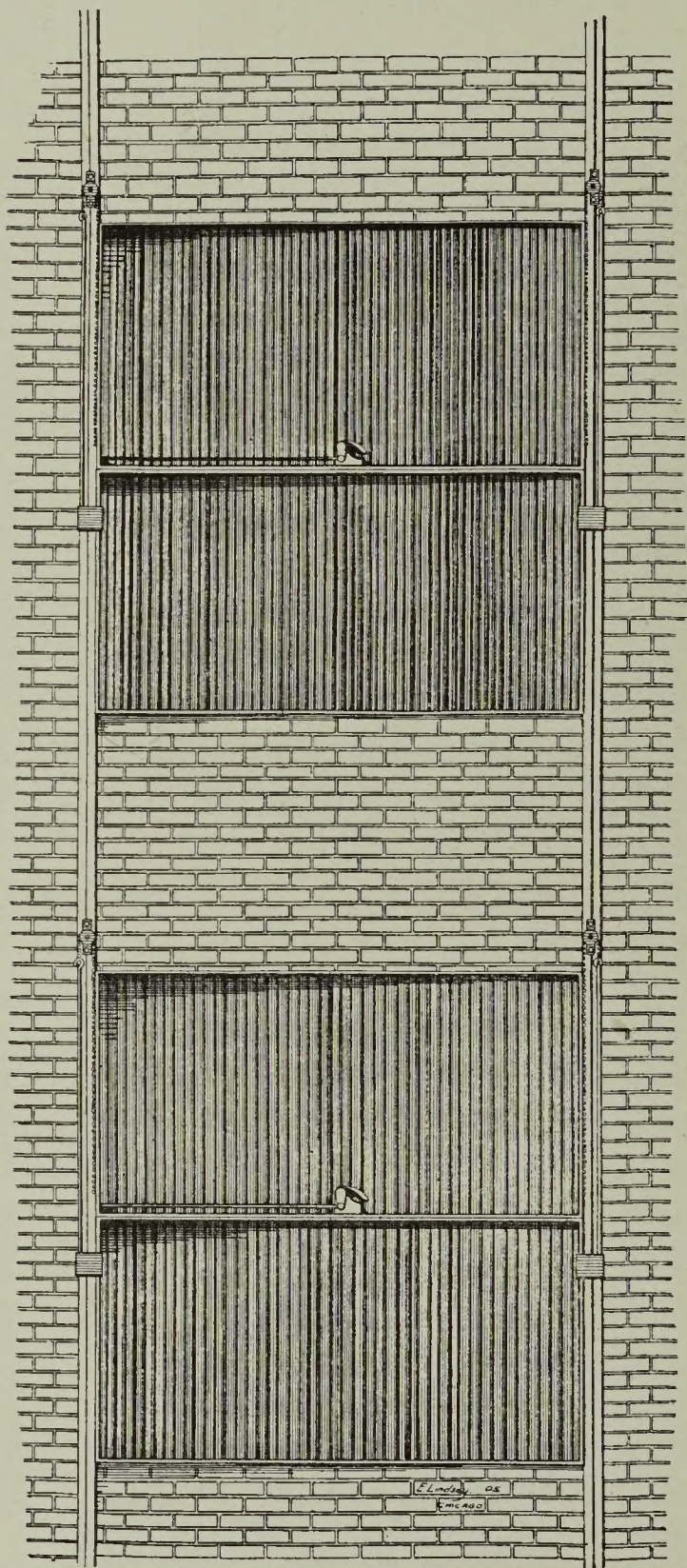

Looking at line of doors from inside of shaft.

Cross Counterbalance Freight Elevator Door

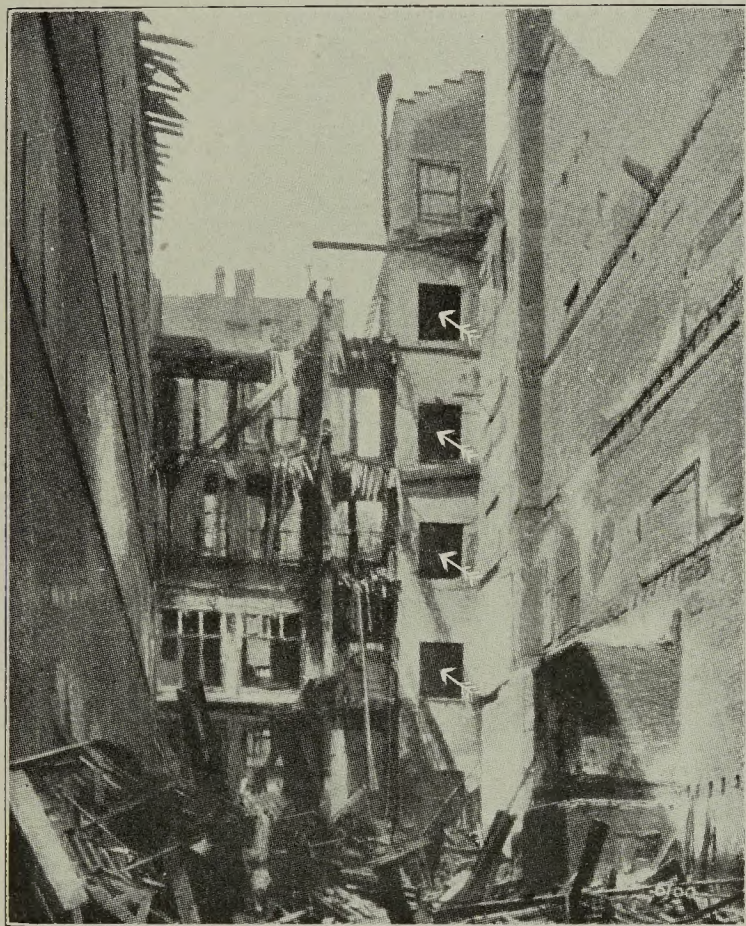

An actual demonstration of what they will do in a fire, showing the Cross Patent Freight Elevator Door intact in the elevator shaft in ruins of Thos. Church Co's. building, 149-151 Wabash Avenue, one of Chicago's fiercest fires.

Arrows indicate doors.

Cross Counterbalance Freight Elevator Door

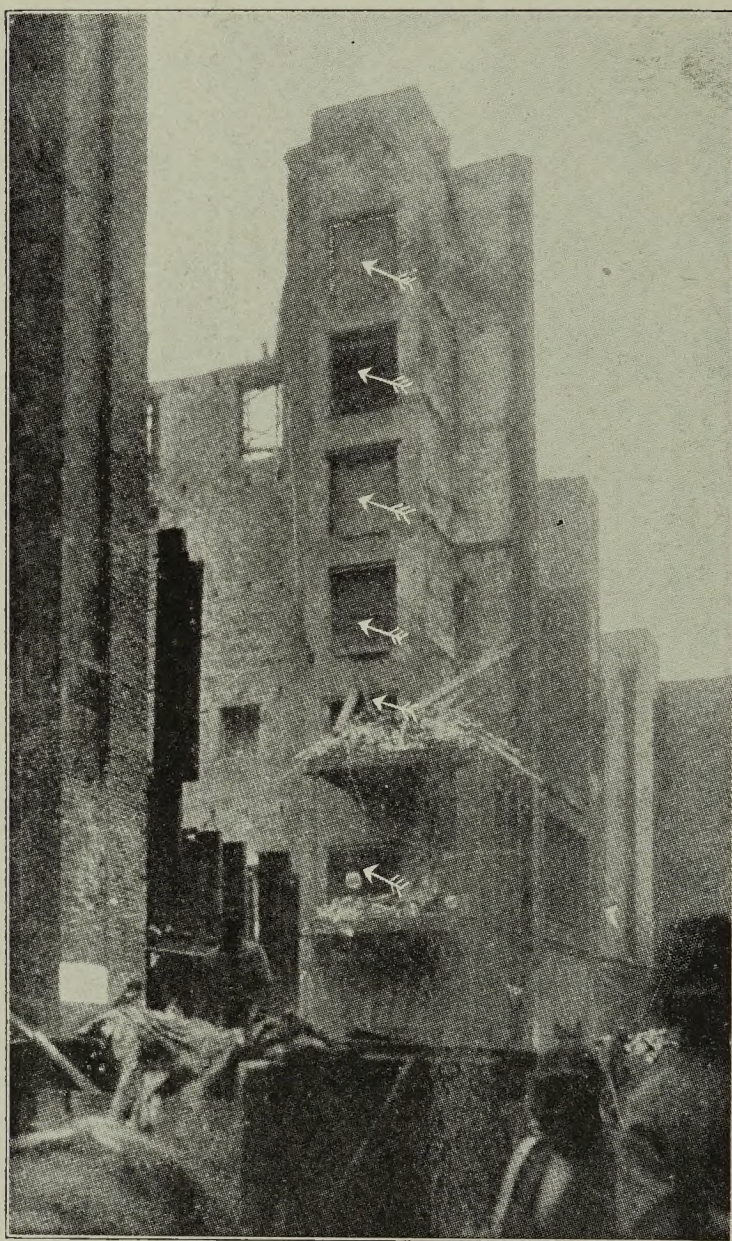

An actual demonstration of what they will do in a fire, showing Cross Patent Freight Elevator Doors standing closed in shaft in ruins of Ayer Building, Wabash Avenue, Chicago, after part of the elevator shaft had fallen away. This closed condition largely prevented the spread of the fire.

Arrows indicate doors.

Cross Horizontal Folding Door

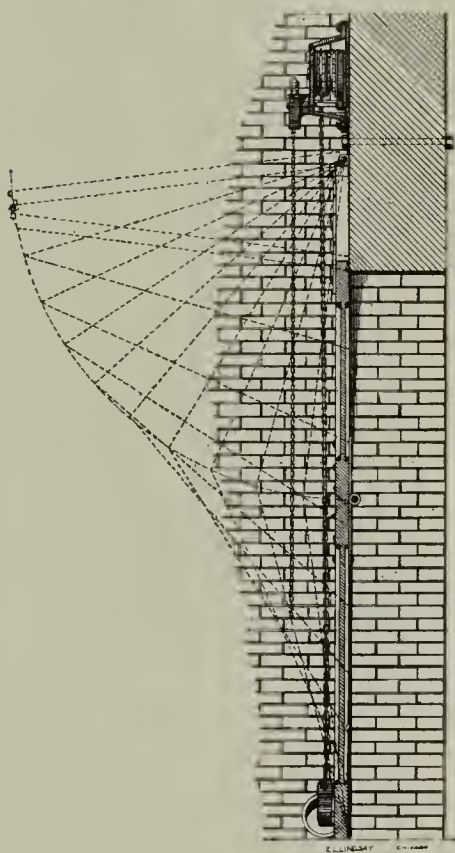
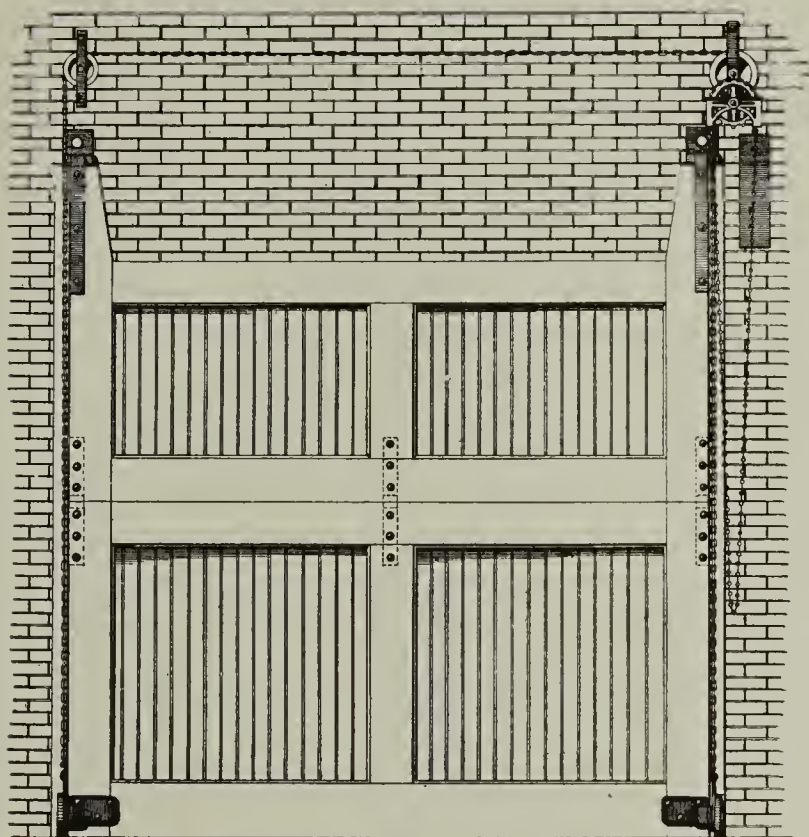

The above cut shows our standard wood construction. This door can be made of any material, from wood to concrete. Durable—simple. First cost is reasonable, and cost of maintenance practically nothing.

Write for further particulars.



Showing the Cross Horizontal Folding Door installed on outside of garage.
Our canopy construction.

The Variety Steel Rolling Doors and Shutters

For use in and on freight houses, warehouses, train sheds, shipping platforms, docks, street car barns, car entrances, dry kilns, etc.

Write for detailed drawings.

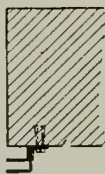
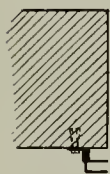
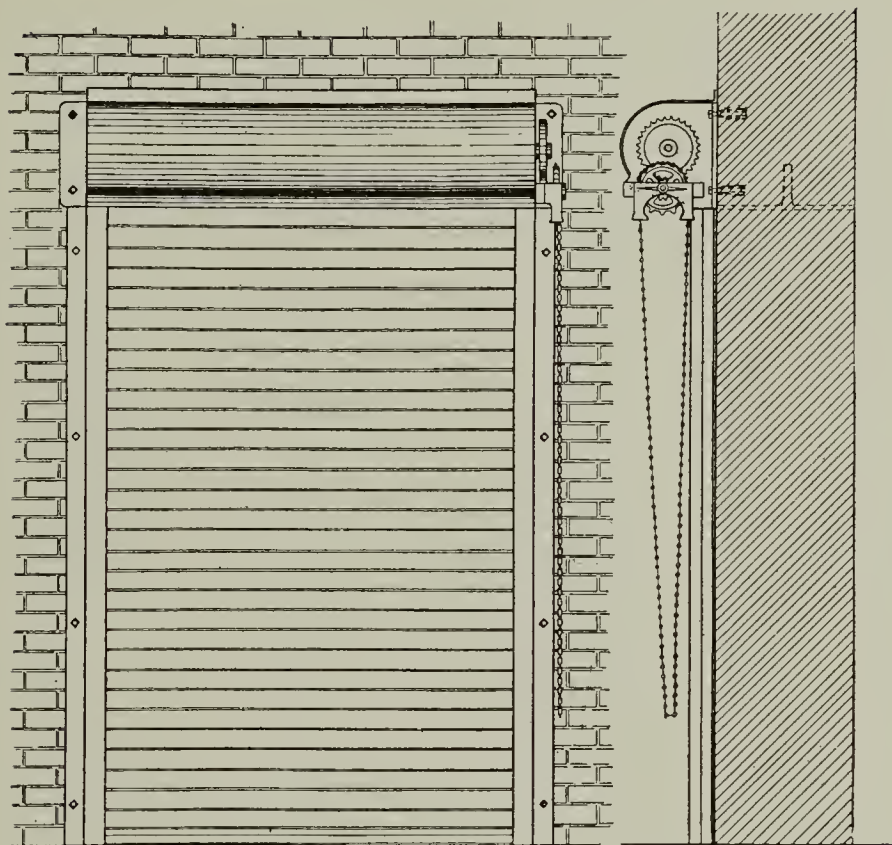

Construction No 20. Operated with hoist and chain

This construction is used for large openings. The supporting brackets and steel grooves are attached to the wall with expansion bolts or bolts through the wall.

The Variety Steel Rolling Doors and Shutters

For use in and on freight houses, warehouses, train sheds, shipping platforms, docks, street car barns, car entrances, dry kilns, etc.

Write for detailed drawings.

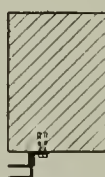
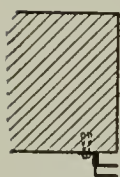
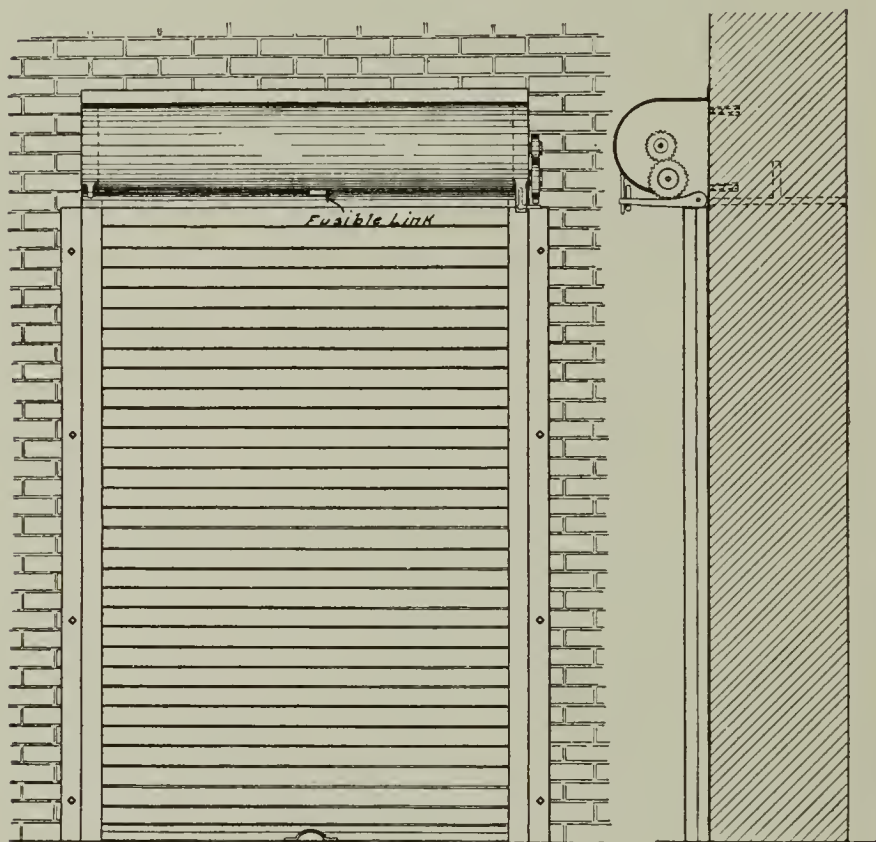

Construction No. 33. Operates automatically in case of fire.
Can also be operated by hand

This shutter is released and closed automatically by a fusible link which melts at a temperature of 160 degrees; it is counterbalanced with springs and operates easily by hand. Recommended for use on elevator shafts and stairway and window openings.

The Variety Steel Rolling Doors and Shutters

For use in and on freight houses, warehouses, train sheds, shipping platforms, docks, street car barns, car entrances, dry kilns, etc.

Write for detailed drawings.

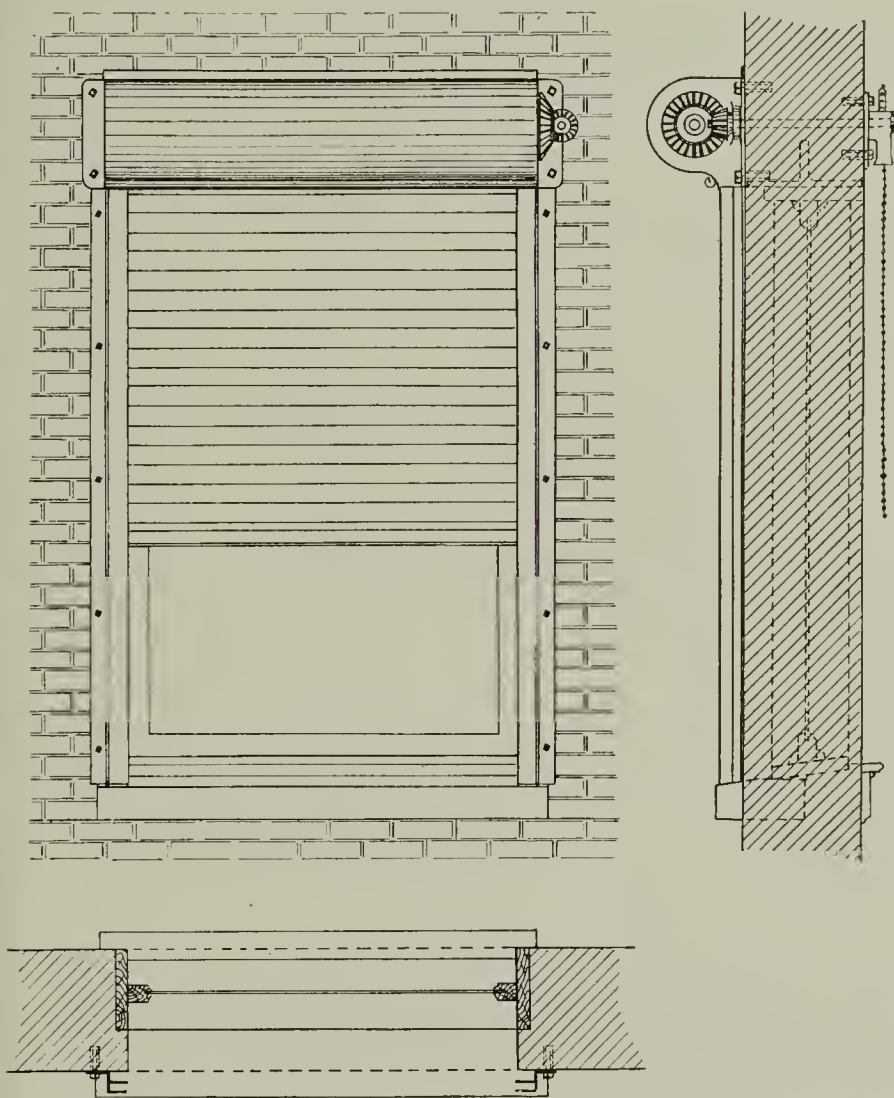

Construction No. 38. Operated by hoist and chain

Showing shutter hung on outside of building operated by hoist from inside, using a bevel gear and running shaft through wall. Where it is necessary to put shutter on outside, as in this case, we recommend the use of galvanized steel.

The Variety Steel Rolling Doors and Shutters

For use in and on freight houses, warehouses, train sheds, shipping platforms, docks, street car barns, car entrances, dry kilns, etc.

Write for detailed drawings.

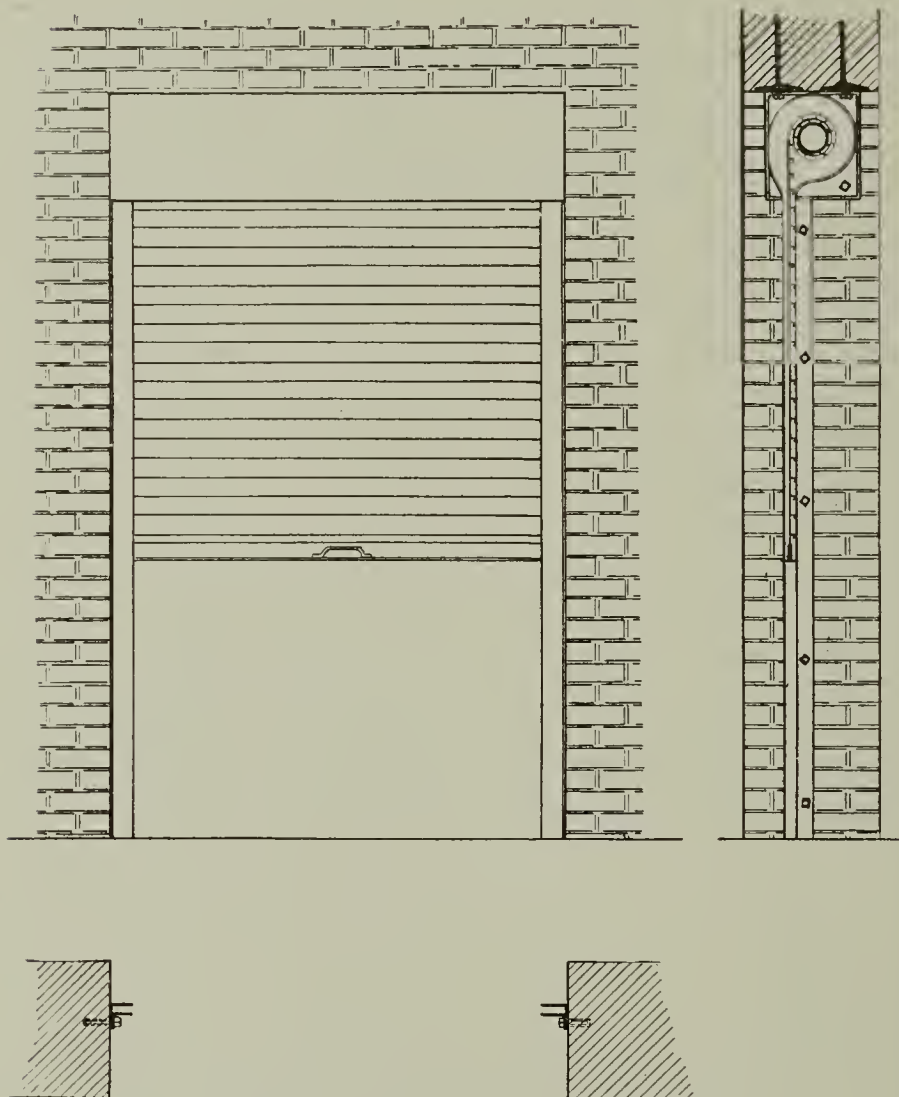

Construction No. 41. Operated by hand

Standard construction where conditions are such that the shutter cannot be placed on face of wall; showing shutter between jambs; operated by hand or chain hoist, depending on size of opening.

Tin Clad Underwriters Fire Doors

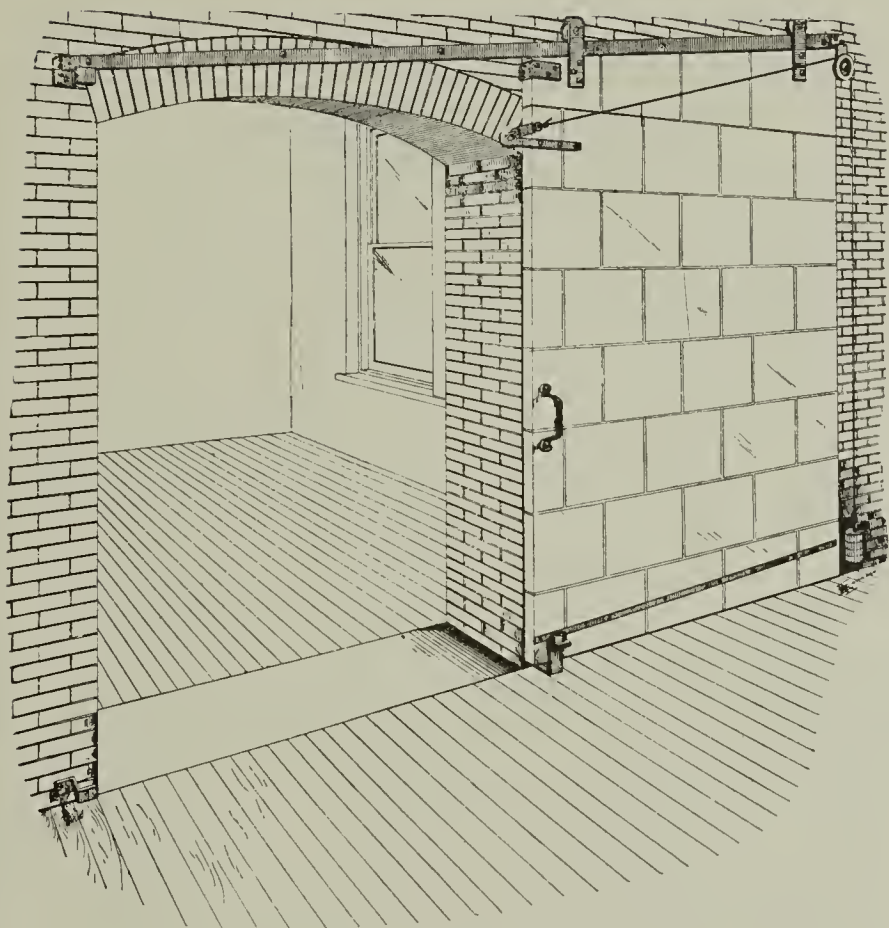

Showing standard Underwriters Tin Clad Sliding Fire Wall Door, built of three thicknesses $\frac{7}{8}$ x 6-inch dressed and matched white pine, tinned according to Underwriters' specifications. We guarantee this door to be acceptable to the Underwriters anywhere in the country. We sell the hardware only, or both door and hardware f. o. b. Chicago; or we will take contracts to erect.

Standard Swing Underwriters Fire Door

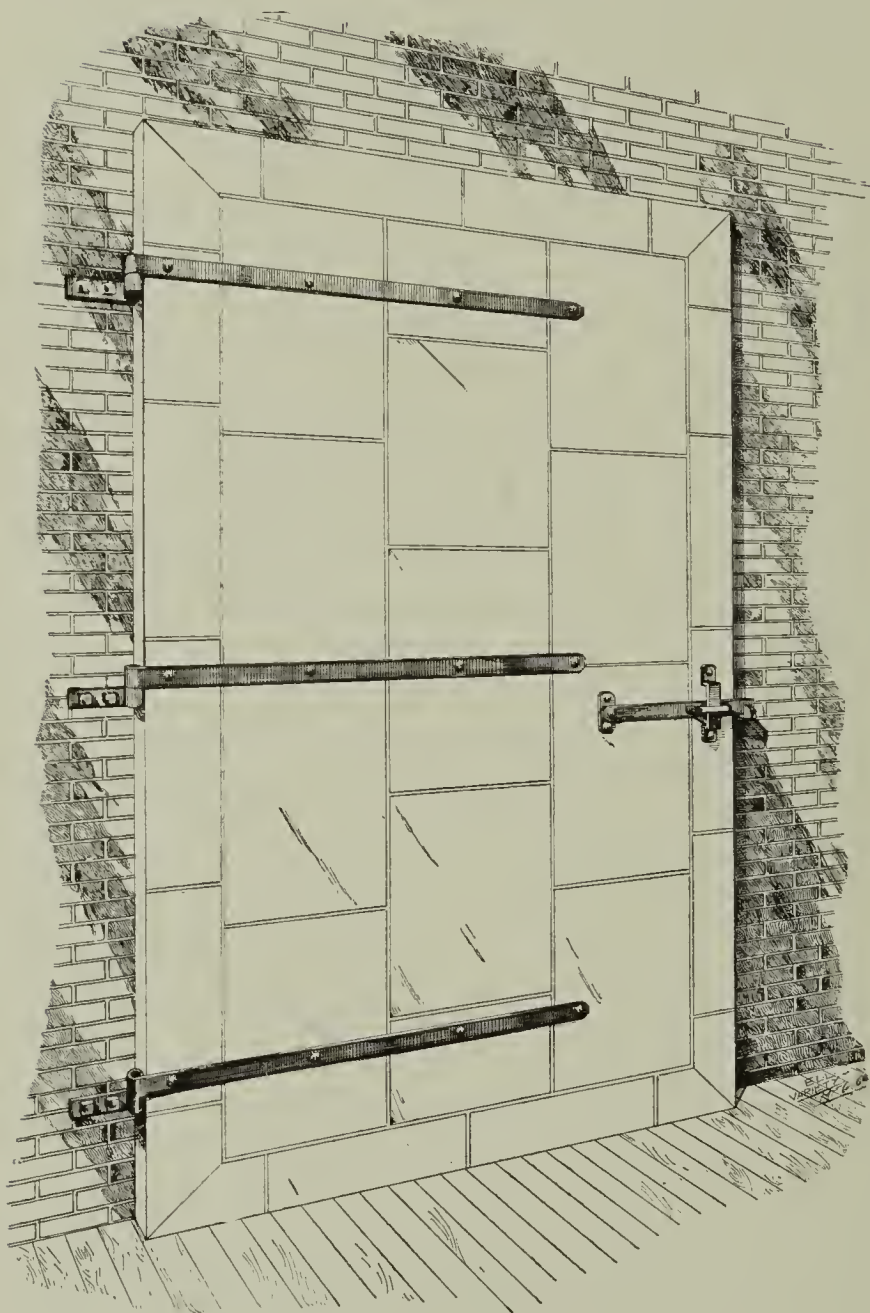

Cut showing standard Underwriters Tin Clad Swing Door, constructed the same as the sliding door. We sell the hardware only, or door and hardware complete f. o. b. Chicago; or make contract to erect in place.

Standard Single Swing Iron Door

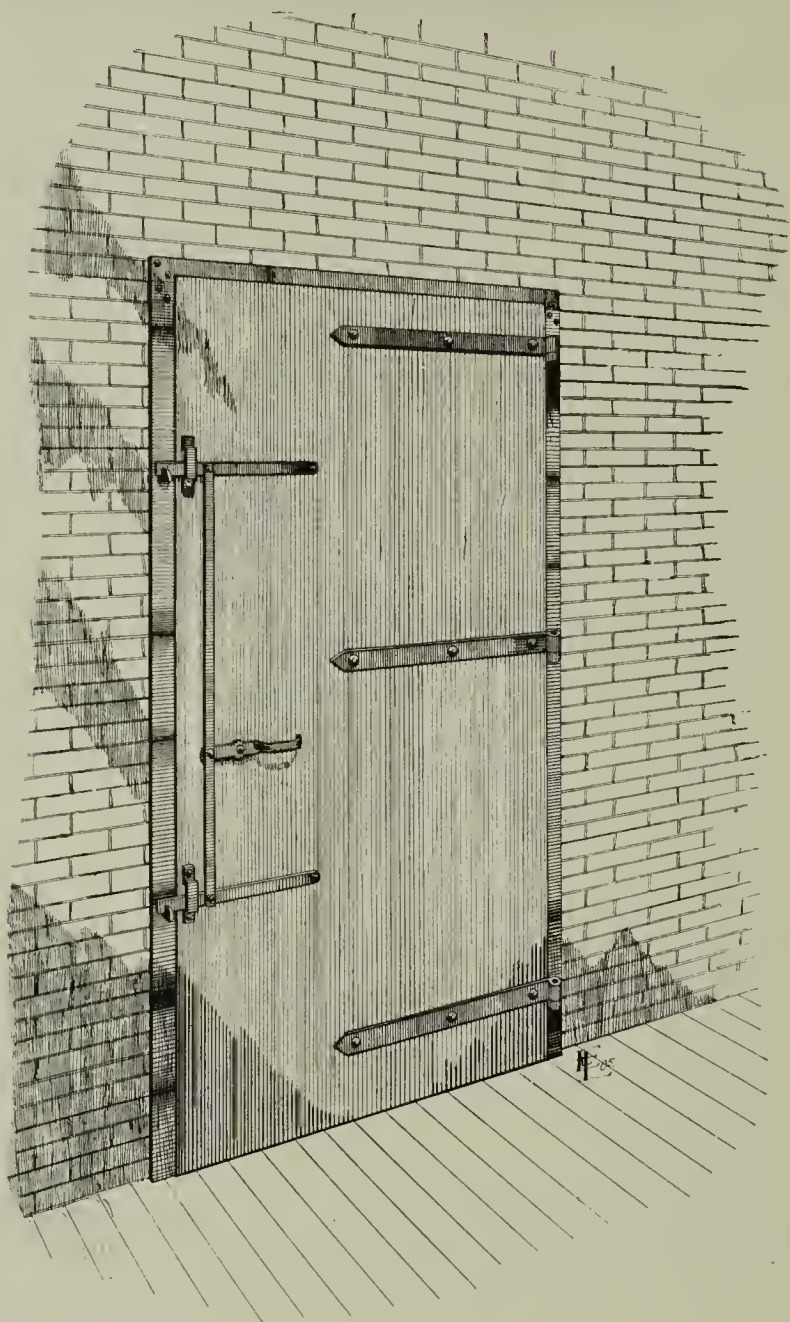

Showing Standard Underwriters Swinging Iron Door, built of No. 12 or $\frac{3}{16}$ -inch plate steel hung on angle iron frame, as shown on page 19.

We guarantee this door to be acceptable to the Underwriters anywhere in the country, and will sell it either f. o. b. Chicago or take contract to erect complete in place.

Standard Iron Door Wall Frame

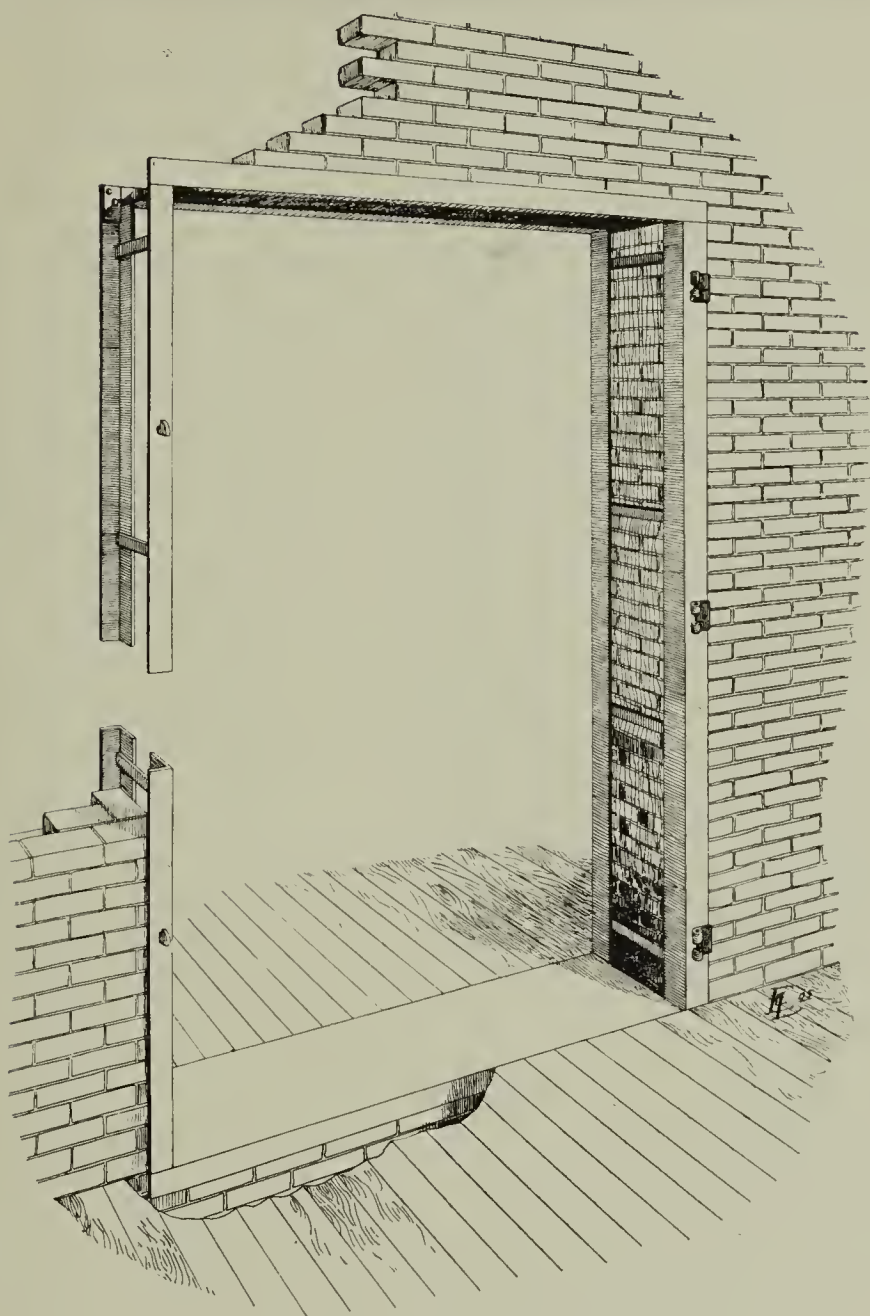

Showing Standard Wall Frame for sliding and swinging Standard Underwriters Steel Doors. Can be built in as building goes up or can be installed after wall is up. We sell either f. o. b. Chicago or erect in place.

Standard Sliding Iron Door

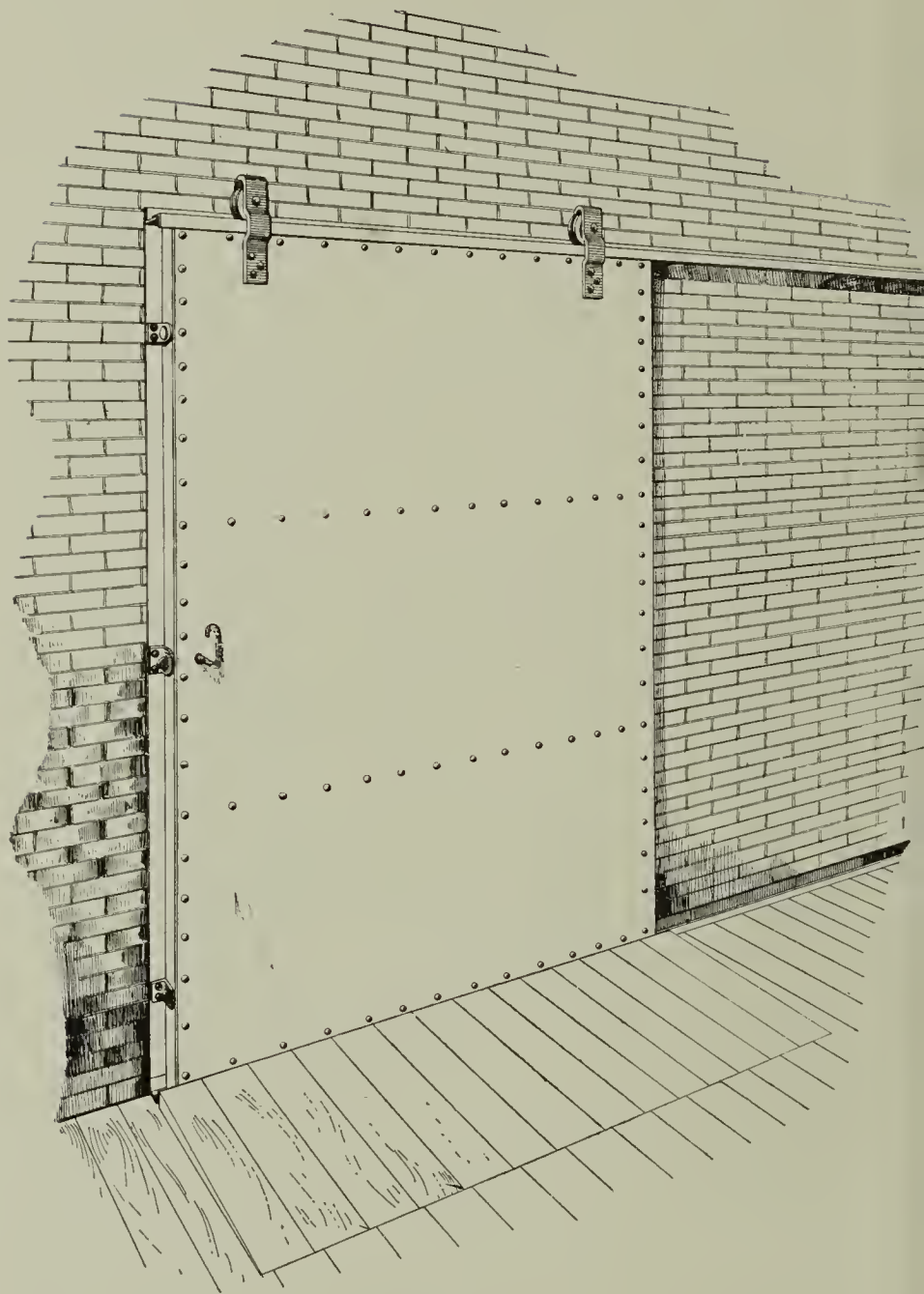

Showing Standard Underwriters Steel Sliding Door built of No. 12 gauge or $\frac{3}{16}$ -inch plate steel. We sell these doors either f. o. b. Chicago or take contract to erect complete in place. We guarantee these doors to be acceptable to the Underwriters anywhere in the country.

Standard Double Swing Iron Door

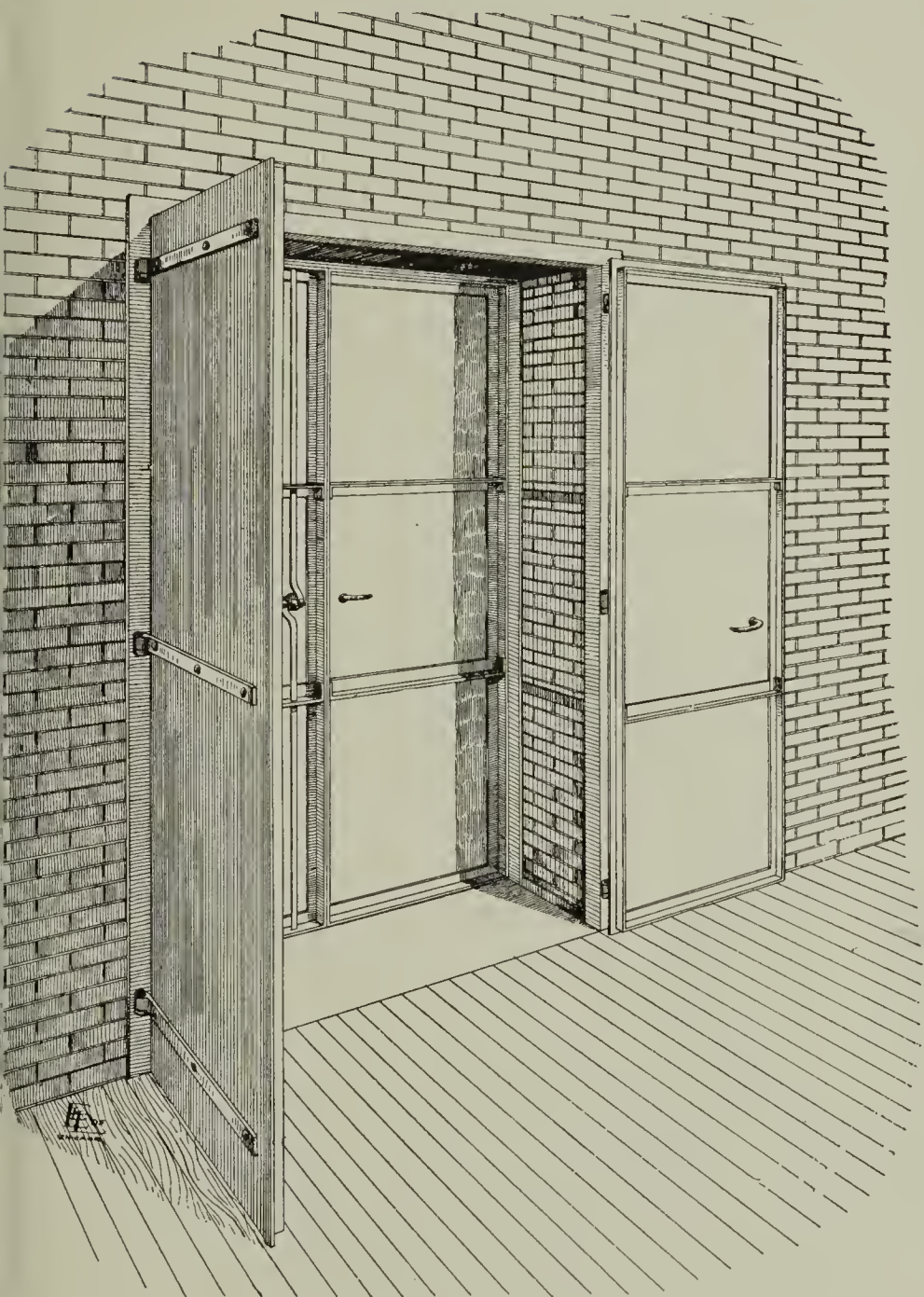

Showing Standard Swinging Steel Fire Wall Doors hung on angle frames as shown on page 19. We guarantee these doors to be acceptable to the Underwriters anywhere in the country, and sell them either f. o. b. Chicago or take contract to erect complete in place.

Standard Double Swing Iron Window Shutters — Open

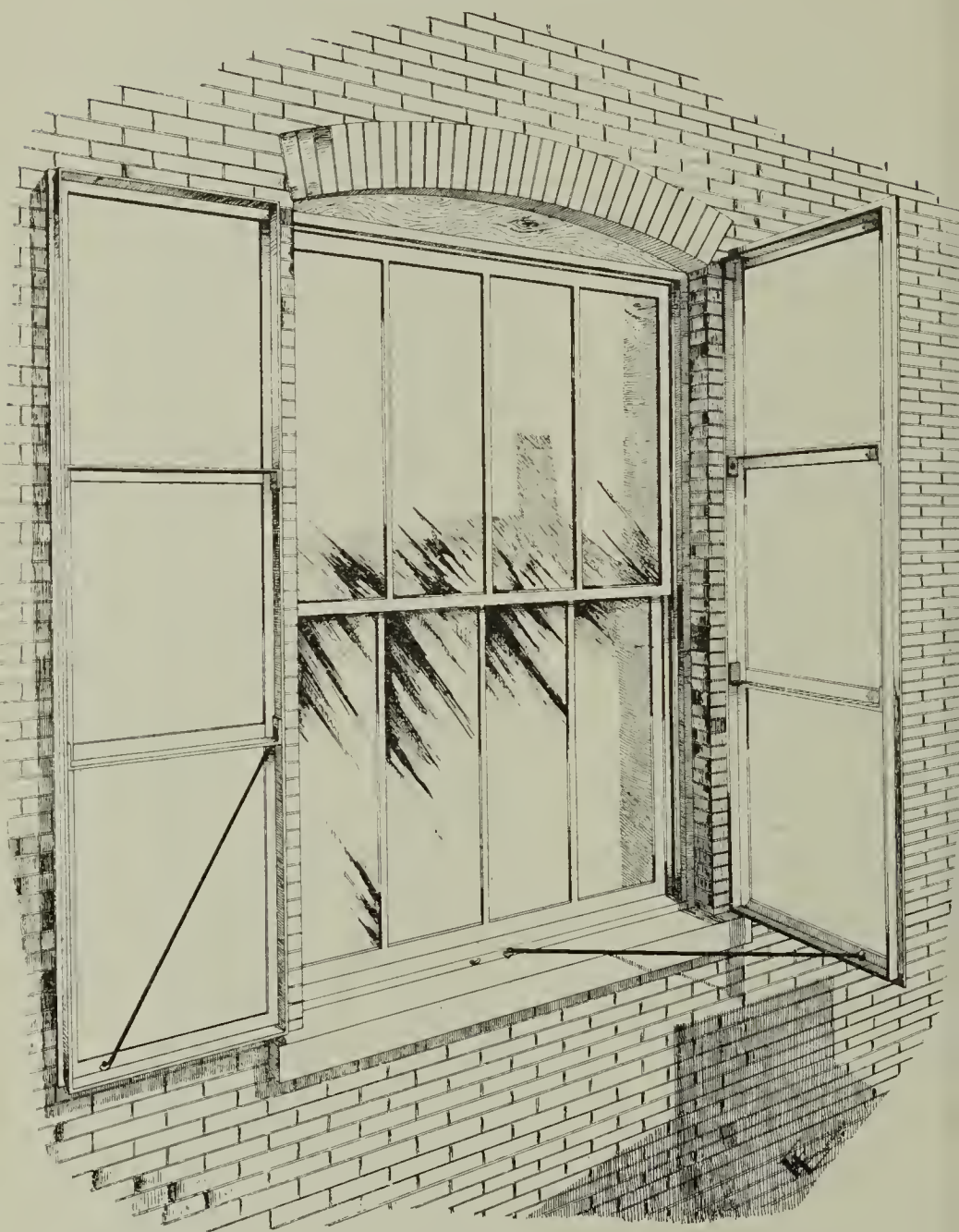

Showing Standard Window Shutters, built of No. 14 gauge steel. We furnish the shutter, together with the eyes, and take contract either to erect complete in place or furnish f. o. b. Chicago.

Standard Swing Window Shutters Closed

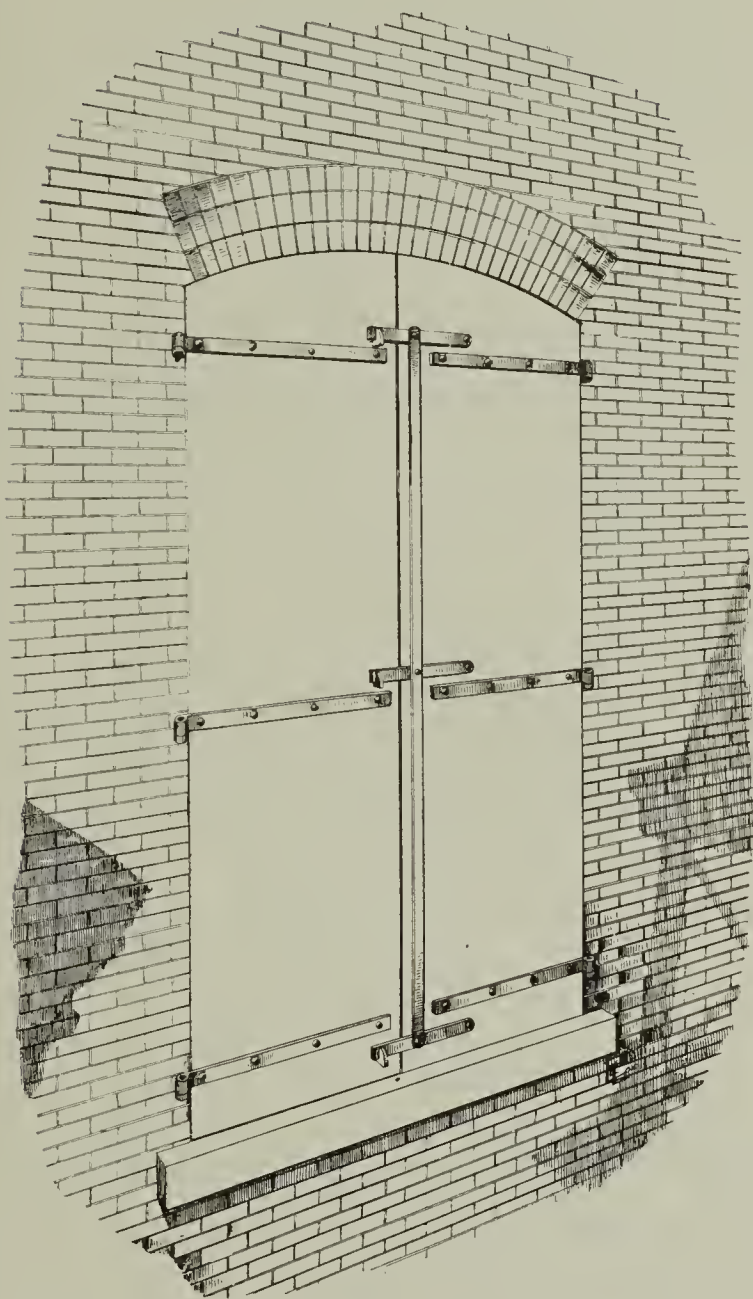

Showing our Standard Window Shutters, made of No. 14 gauge steel, reinforced with angle irons, in accordance with specifications of Underwriters.

Fire Escapes

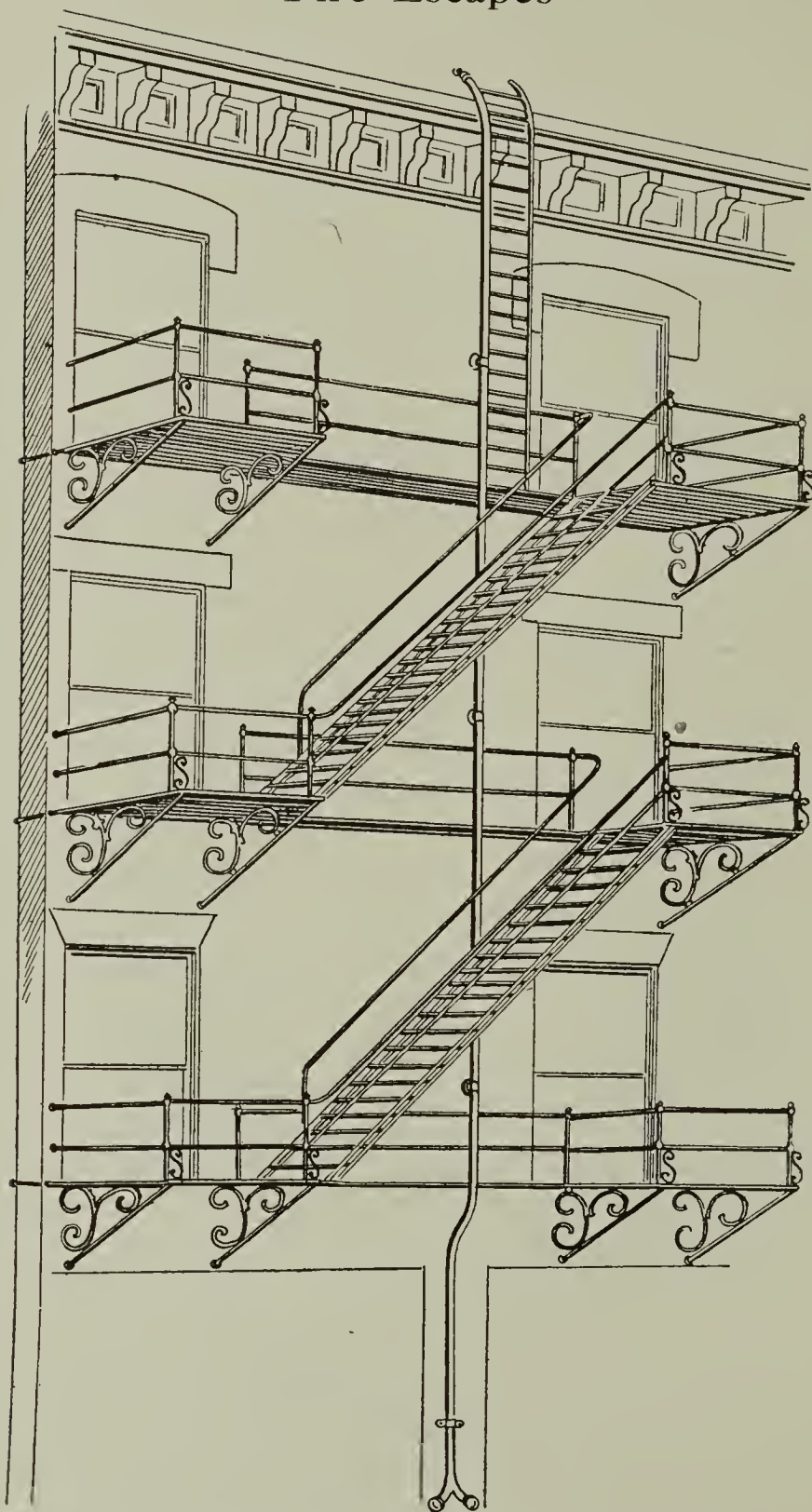

This cut represents Stairway Fire Escape especially adapted for public halls and large factories.
Counterbalanced stair furnished when desired.

Fire Escapes

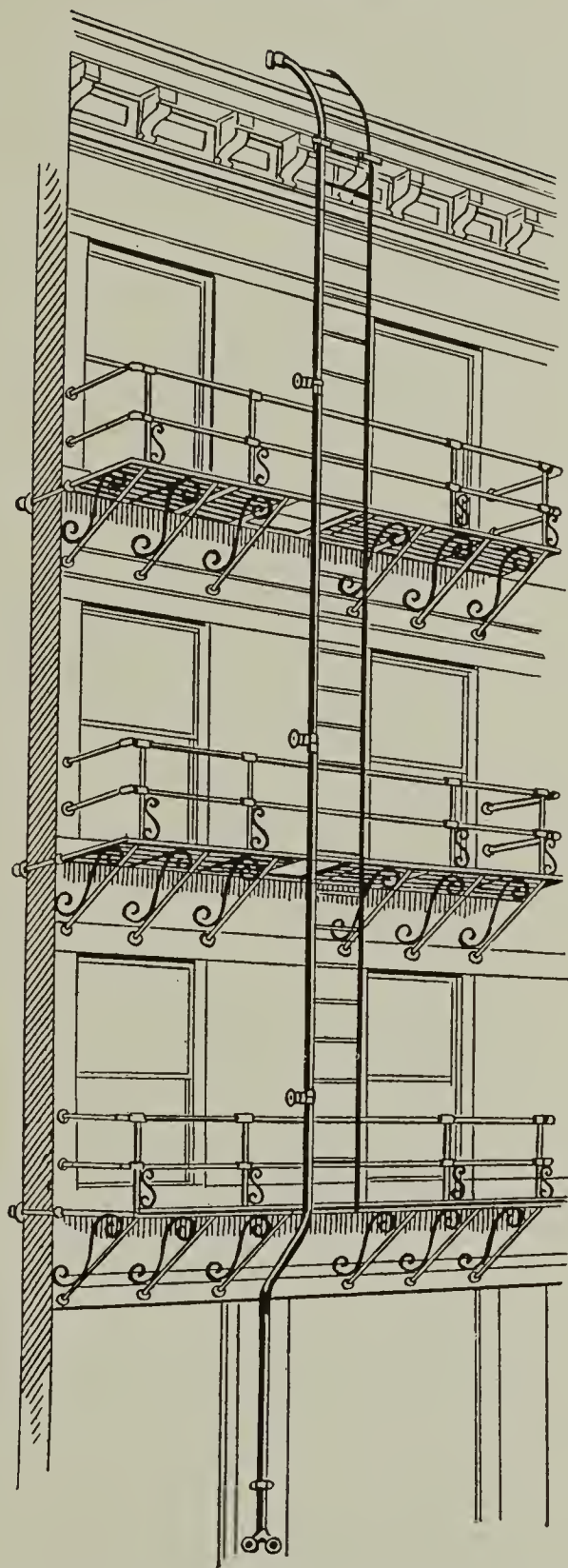

Standpipe and Ladder combined, with double balconies so arranged as to protect two buildings.

Plain or ornamental railing and brackets furnished as desired.

Fire Escapes

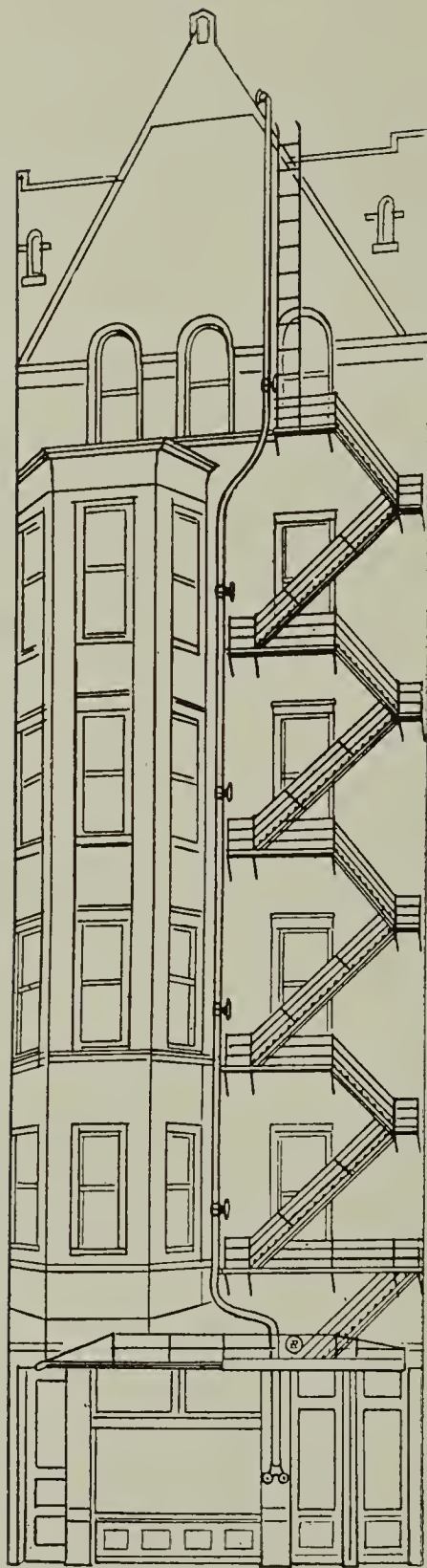

Stairway Fire Escape with Counterbalanced Stair,
adapted for theatres, hospitals and public buildings.
Showing counterbalanced stair raised.

Fire Escapes

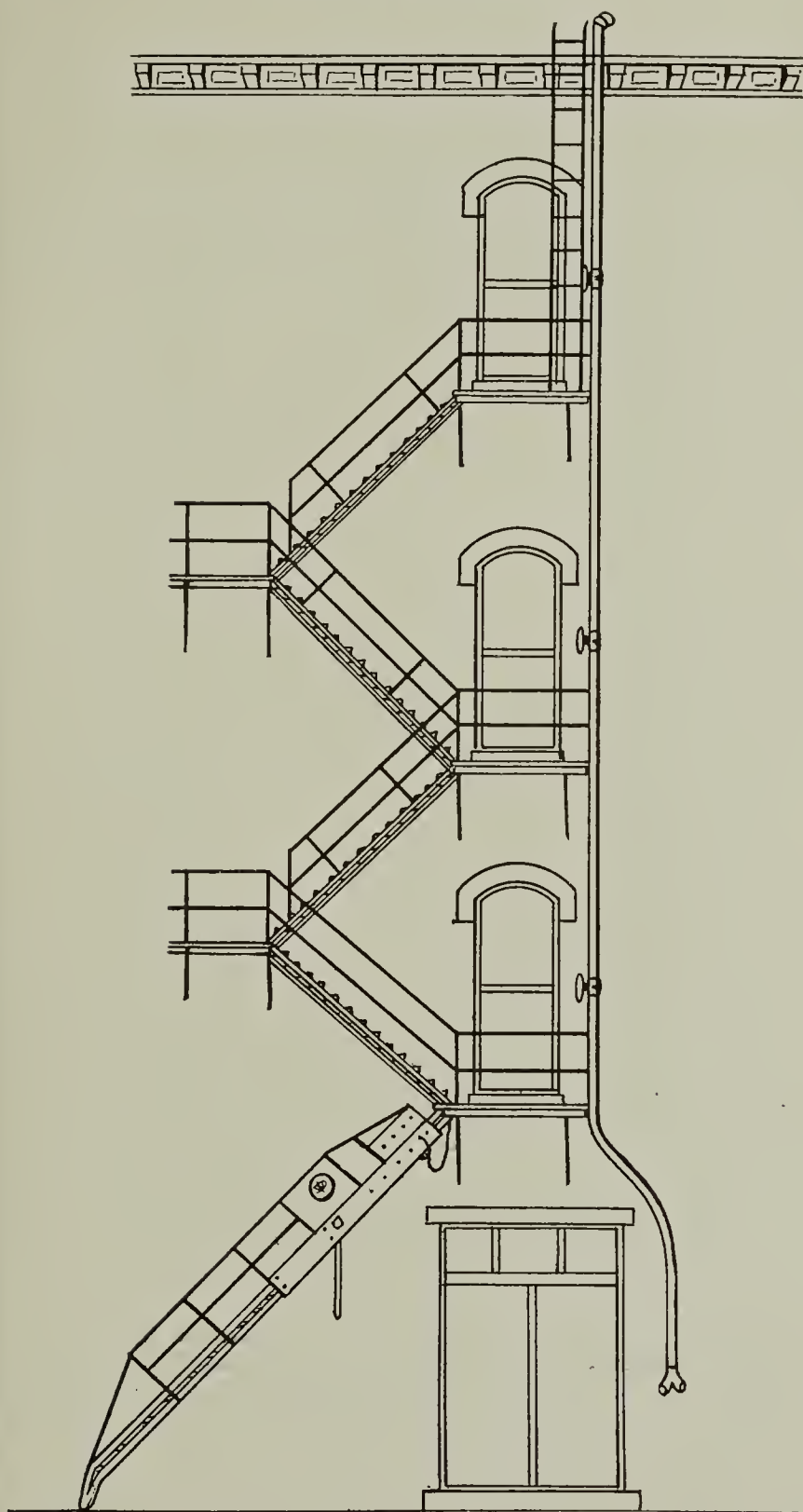

Stairway Fire Escape with Counterbalanced Stair,
especially adapted for schools, hotels and factories.
Showing counterbalanced stair lowered.

Window Guards

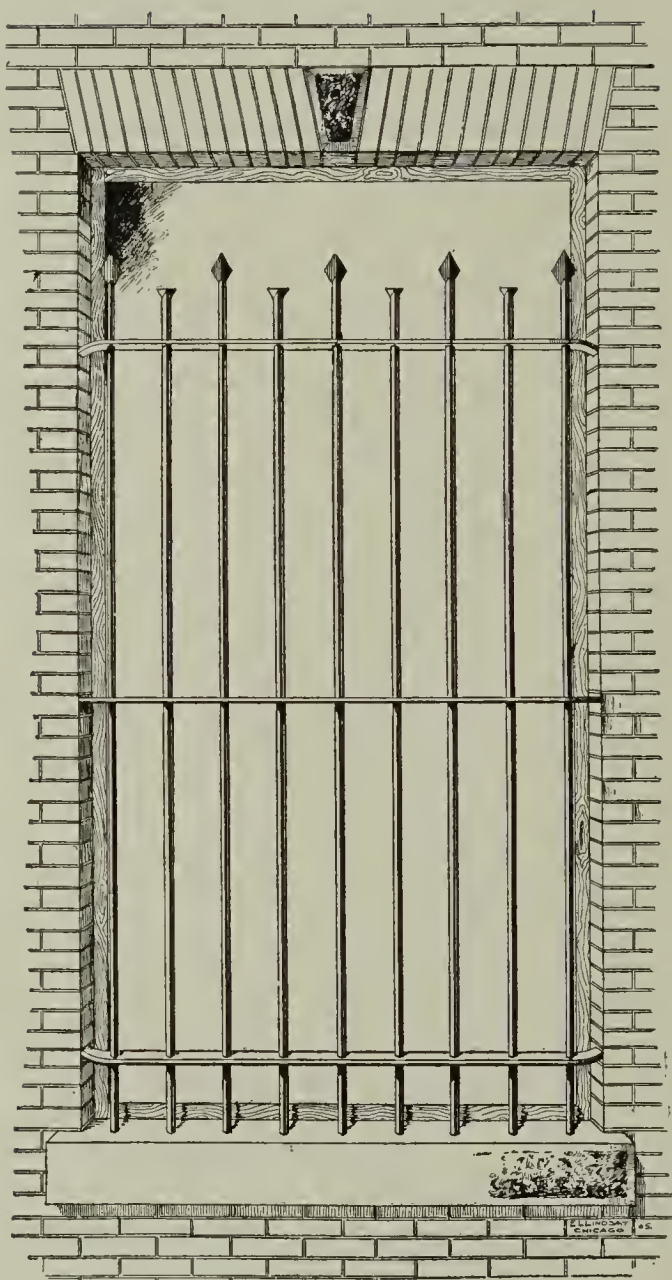

No. 1. Showing Standard Factory Window Guard.

Window Guards

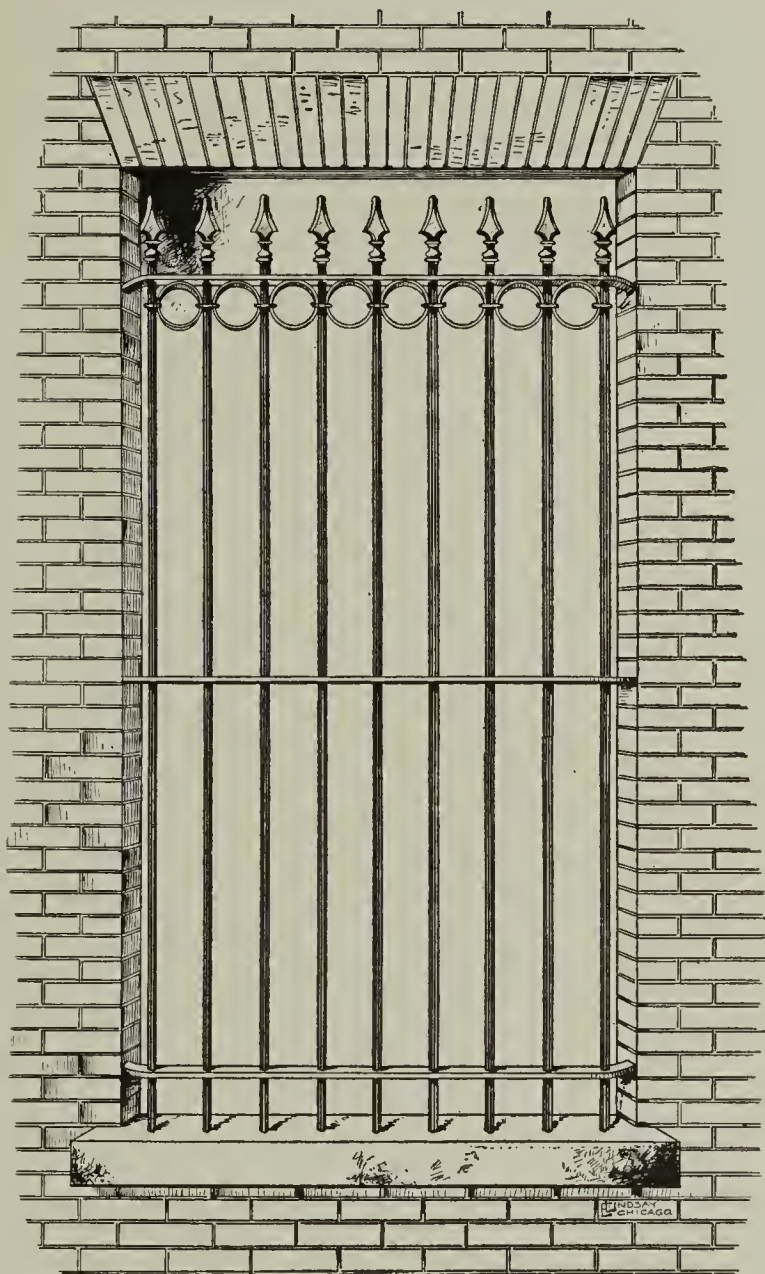

No. 2. Showing Standard Office Window Guard.

Window Guards

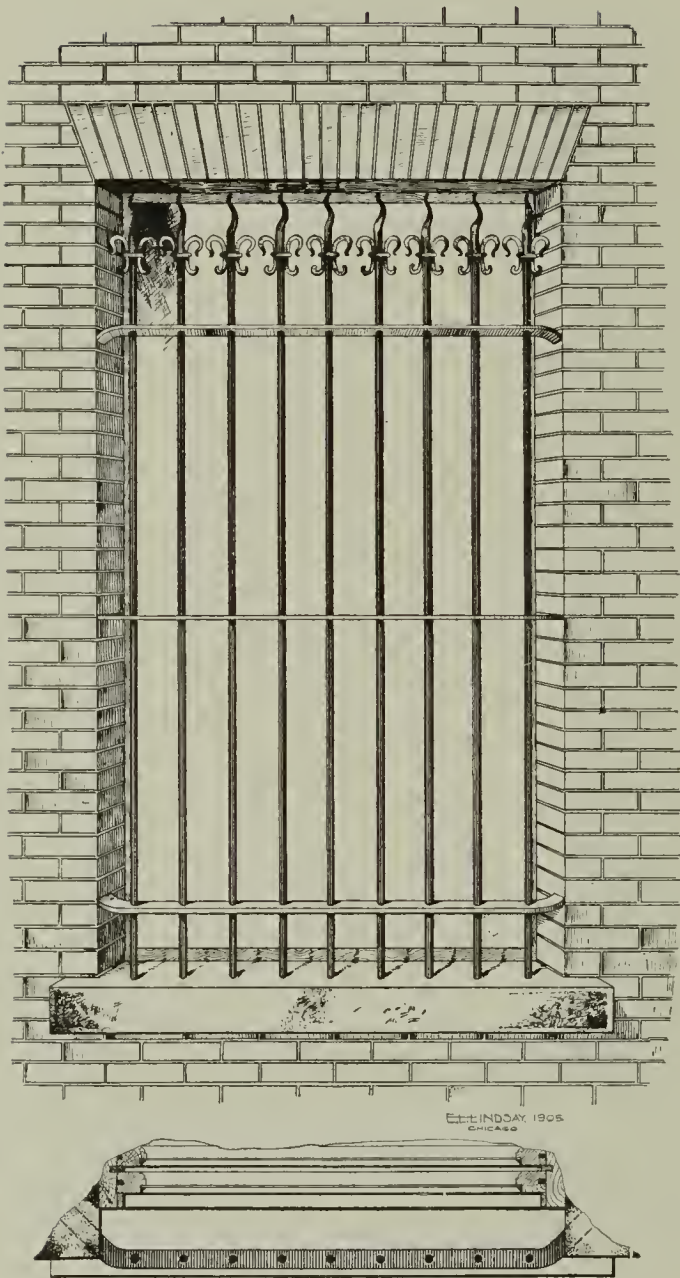

No. 3. Showing Standard Window Guard for basement residence openings.

Window Guards

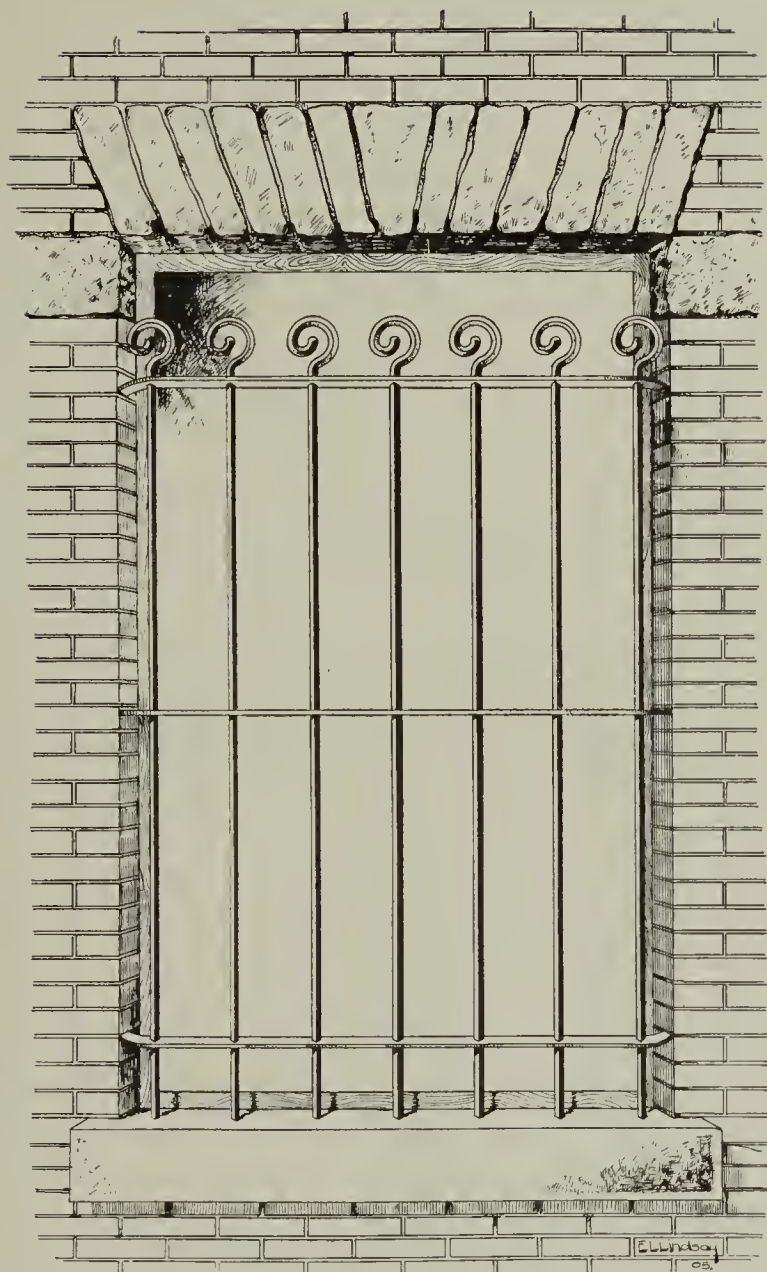

No. 4. Showing Standard Bank Window Guard.

Joist Hangers

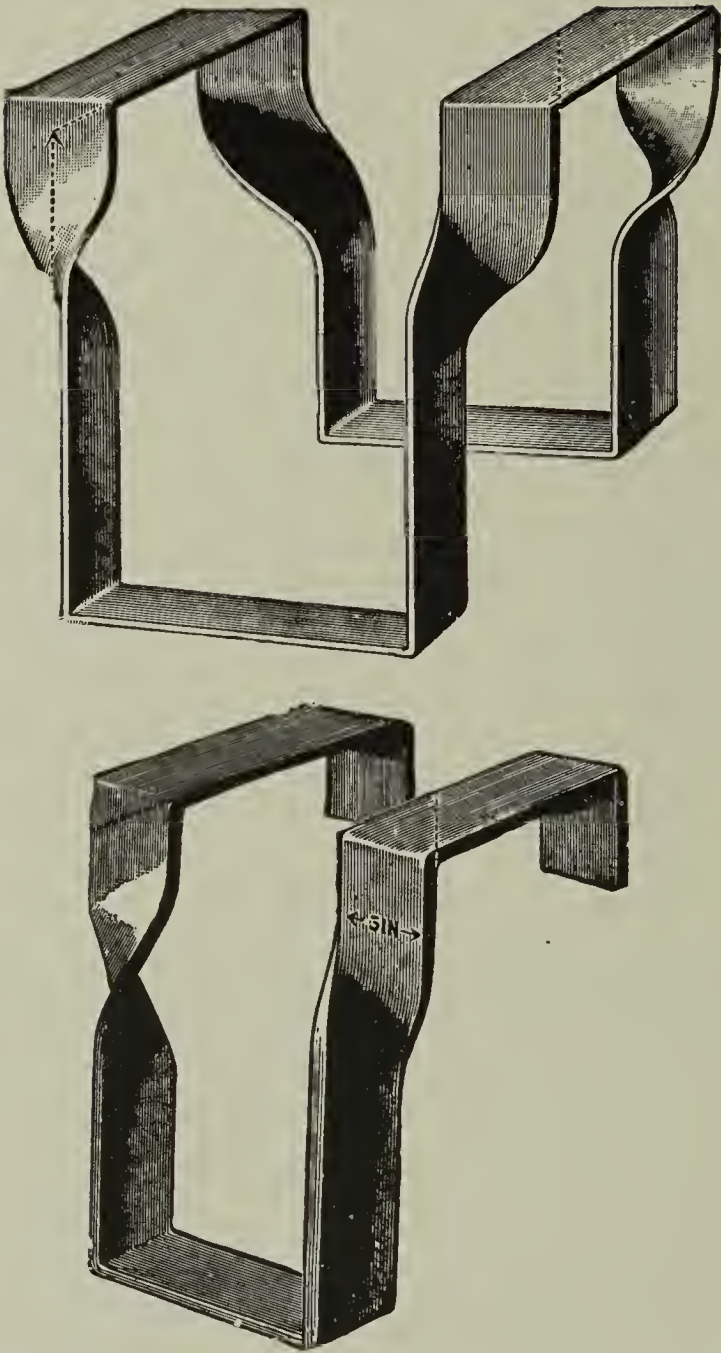

Showing our Standard Joist Hanger made in Singles and Doubles of universal rolled steel bars. Doubles are welded. These hangers are machine-made and are, therefore, accurate as well as being uniform. They are bent hot, so that there is no possible chance of straining the material.

We can undersell any hanger on the market.

Collapsible Folding Gates

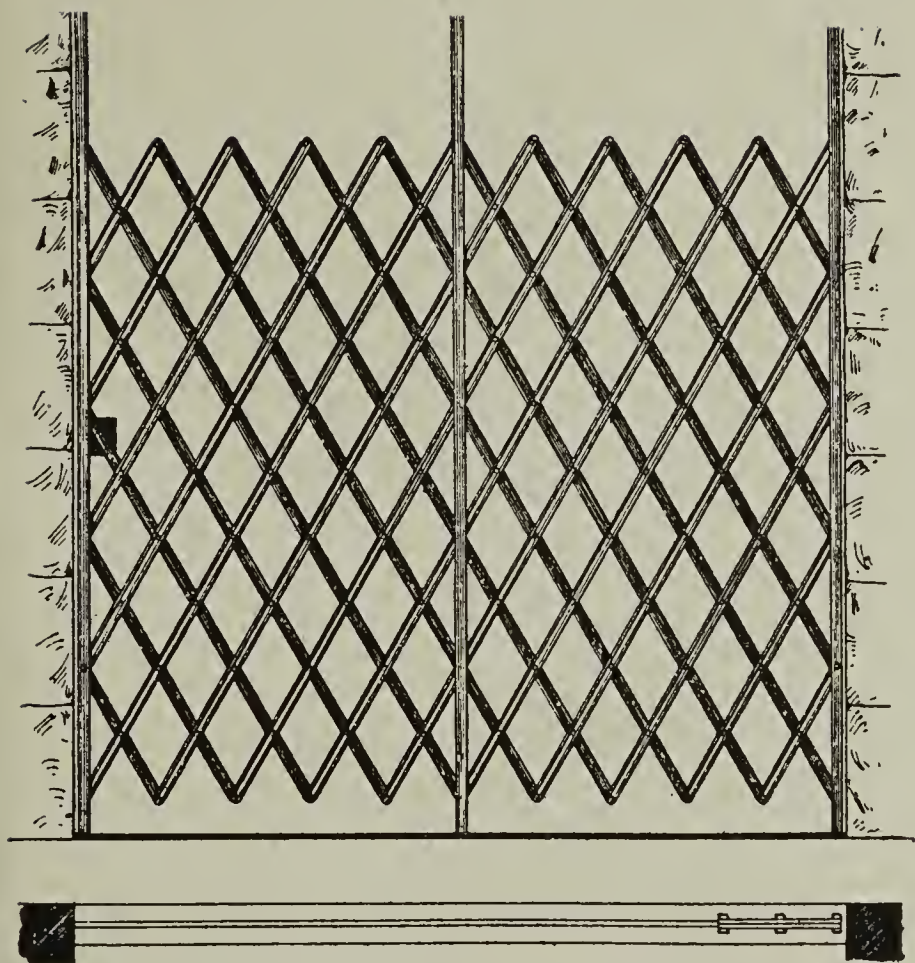

Showing our Collapsible Folding Gate for store fronts, alleyways, etc., made in any size, of any material.

Collapsible Street Gate

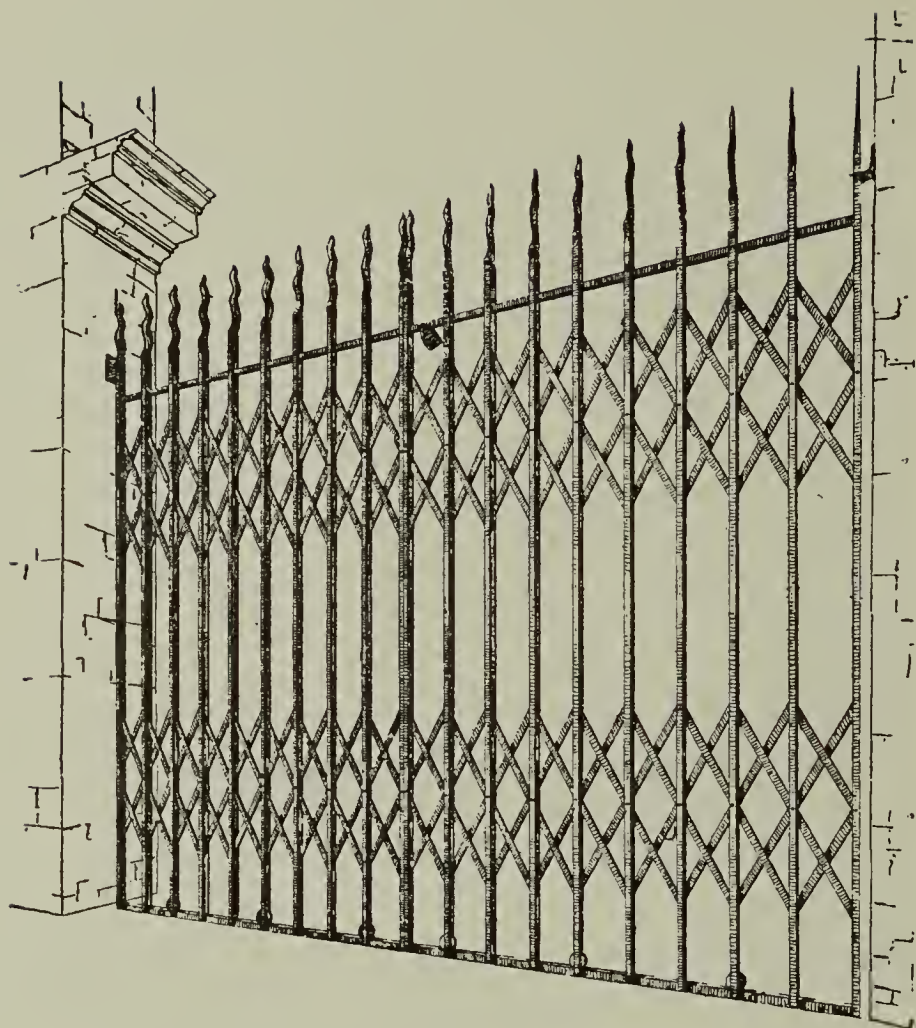

Showing ornamental Collapsible Gate for carriage entrances, passageways, garage fronts, etc.

Sidewalk Doors

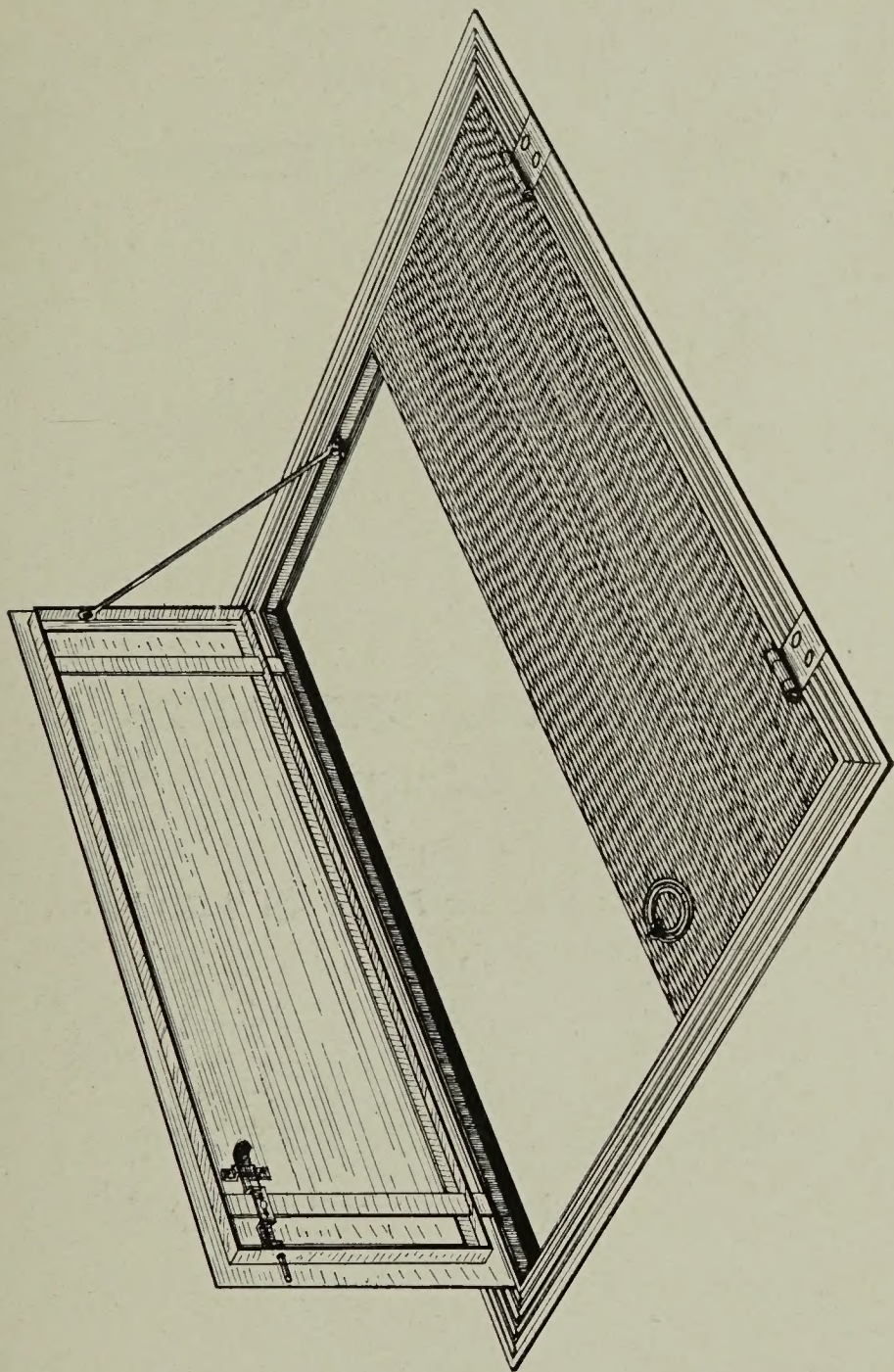

Showing our Standard Sidewalk Door, made of $\frac{3}{16}$ and $\frac{1}{4}$ -inch checkered steel plate, set in an angle iron frame.

Write for prices.

Illustrations of Joist Anchors

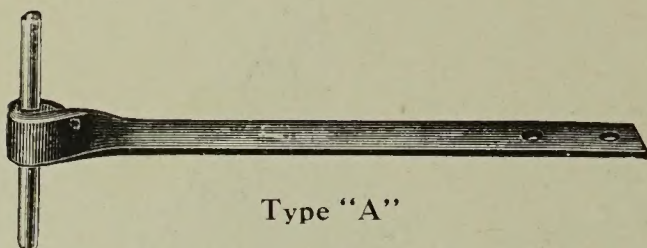

Type "A"

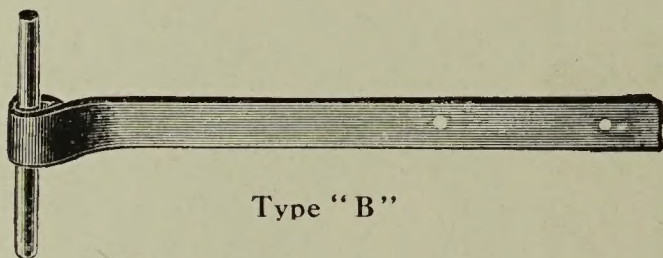

Type "B"

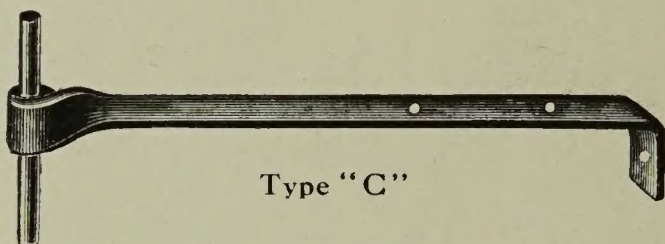

Type "C"

These cuts illustrate our *Pin* or "*T*" *Anchors* for securing joints to masonry.



This is an illustration of our regular *Strap Anchor*.

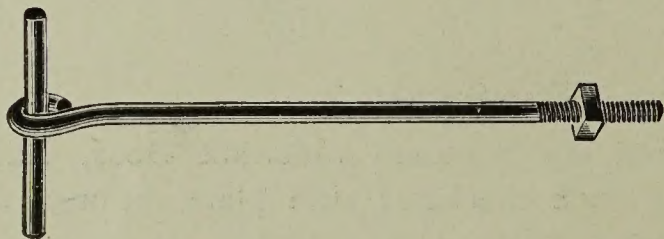

Here is a strong *Curb Wall Anchor* which we furnish in various sizes and lengths.

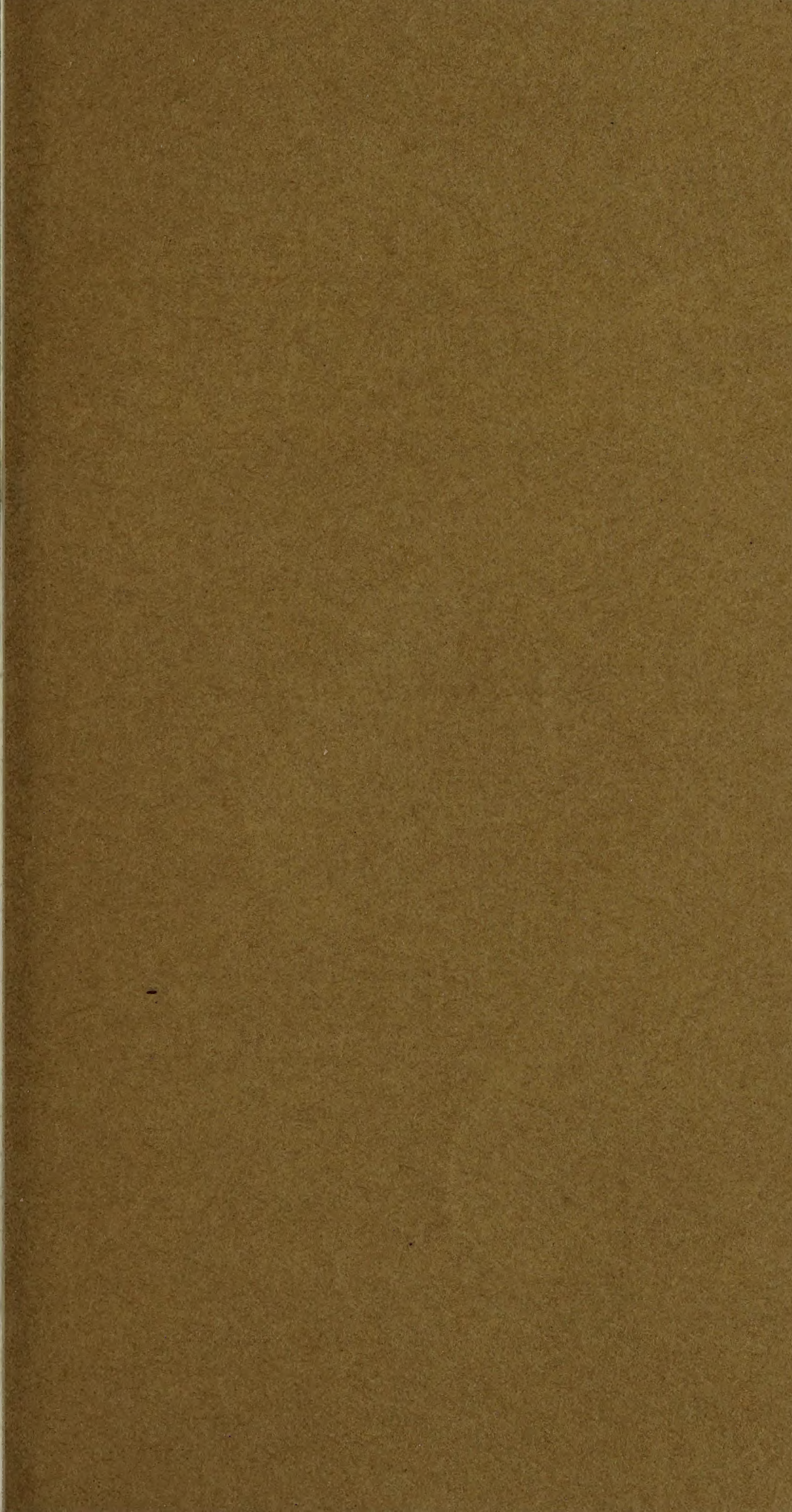

Variety Mfg. Co.
Chicago, Ill.

MANZ ENGRAVING COMPANY
THE HOLLISTER PRESS
CHICAGO